

## KUME12-C

球单轨引导系统

### 技术信息

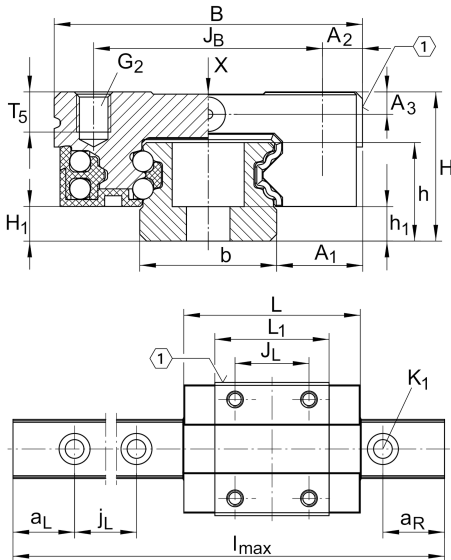

### 主要尺寸和性能数据

|                 |         |                                   |
|-----------------|---------|-----------------------------------|
| H               | 13 mm   | Height system                     |
| B               | 27 mm   | Width carriage                    |
| L               | 35.8 mm | Overall length carriage           |
| C               | 2,900 N | Dynamic load rating               |
| C <sub>0</sub>  | 5,200 N | Static load rating                |
| M <sub>0x</sub> | 33 Nm   | Static moment rating about X axis |
| M <sub>0y</sub> | 17 Nm   | Static moment rating about Y axis |
| M <sub>0z</sub> | 17 Nm   | Static moment rating about Z axis |

### 安装尺寸

|                               |        |                           |
|-------------------------------|--------|---------------------------|
| G <sub>2</sub>                | M3     | Fixing screws             |
| G <sub>2</sub> M <sub>A</sub> | 2.2 Nm | Maximum tightening torque |
| K <sub>1</sub>                | M3     | Fixing screws             |
| K <sub>1</sub> M <sub>A</sub> | 2.2 Nm | Tightening torque         |

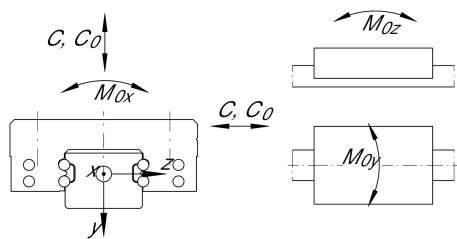

## 尺寸

|             |          |                                |
|-------------|----------|--------------------------------|
| $A_1$       | 7.5 mm   | Distance                       |
| $A_2$       | 3.5 mm   | Distance                       |
| $A_3$       | 1.95 mm  | Position lubrication connector |
| $a_{L\max}$ | 20 mm    | Distance                       |
| $a_{L\min}$ | 5 mm     | Distance                       |
| $a_{R\max}$ | 20 mm    | Distance                       |
| $a_{R\min}$ | 5 mm     | Distance                       |
| $b$         | 12 mm    | Width rail                     |
| $H_1$       | 3 mm     | Distance                       |
| $h$         | 8.6 mm   | Height                         |
| $h_1$       | 3 mm     | Length                         |
| $J_B$       | 20 mm    | Mounting dimension             |
| $J_L$       | 15 mm    | Mounting dimension             |
| $j_L$       | 25 mm    | Increment                      |
| $L_1$       | 23.2 mm  | Carrier length                 |
| $l_{\max}$  | 1,000 mm | Length maximum                 |
| $T_5$       | 3.5 mm   | Thread length                  |